

SMA BULKHEAD FEMALE

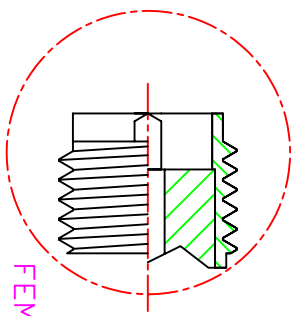

FEMALE RP

INFORMATION

SMA CONNECTOR

1. INSULATOR : TEFLON UL94V-0, WHITE
 2. BODY : BRASS, GOLD PLATED
 3. CONTACT : BRONZE, GOLD PLATED
 4. WASHER : BRASS, GOLD PLATED
 5. NUT : BRASS, GOLD PLATED
 6. FERRULE : BRASS, GOLD PLATED
- CABLE : RG178, TRANSLUCENT BROWN

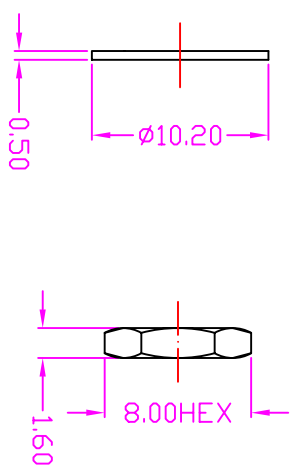

PART NUMBER

CTP-9 0 5 3 0 0 - X - 1 1 3 - 0 6 2

SERIES

- 1: SMA FEMALE
- 2: SMA FEMALE RP

CABLE LENGTH: 113mm

REV.	DATE	DESCRIPTION
B	0722,2013	FERRULE RELEASE
A	0619,2013	RELEASE

<p>Connect-Tech Products Corp. TEL:+1 510 4400578 www.Connect-Tech-Products.com</p>		<p>TOLERANCES XX ±0.3 X.XX ±0.2 X.XXX±0.1 Angle ±5°</p>		<p>05001</p>	
<p>CABLE ASSEMBLY SERIES RG178, SMA BULKHEAD FEMALE RP</p>		<p>DRAWN BY <i>Georas</i></p>		<p>CHECKED BY <i>B. Q. W.</i></p>	
<p>UNIT MM</p>		<p>SCALE NONE</p>		<p>SIZE A4</p>	
<p>DRAW NO. D090-53062</p>		<p>APPROVED BY <i>Shiny</i></p>		<p>REV. B</p>	